

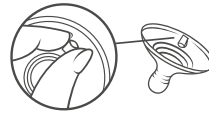

# bottle and teat

## INSTRUCTIONS FOR USE



for best results  
**make sure**  
this valve can open

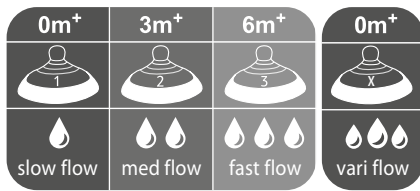

### PRODUCT ASSEMBLY

- A teat
- B screw ring
- C easi-vent™ valve

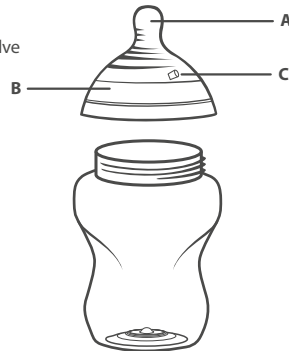

### CLEANING & STERILISING

- ✓ Before first use, clean the product.
  - ✓ Always wash the product immediately after use.
  - ✓ Clean before each use.
  - ✓ Before first use place in boiling water for 5 minutes. This is to ensure hygiene.
  - ✓ Wash in warm soapy water and rinse in clean water or use a dish washer (top shelf only).
  - ✓ For cleaning other bottle parts, use a closer to nature teat & spout brush.
  - ✓ Once you have cleaned your bottles they are ready to sterilise.
  - ✓ All bottle components should be sterilised.
  - ✓ All bottle components are suitable for sterilisation by steam (electric or microwave), boiling or cold water tablet / liquid sterilisation.
- 
- ✗ Do not clean with harsh chemicals.
  - ✗ Do not allow product to come into contact with oil based foods (e.g. oil / tomato based sauces) as staining will occur.
  - ✗ Do not turn the teat inside out for cleaning. Damage could result.
  - ✗ Do not use a teat brush or any other implement to clean the feeding hole in the end of the teat or valve as damage such as splits and tears may occur.
- 
- ✓ **TAKE EXTRA CARE** when cleaning the easi-vent™ valve. In order to ensure optimum venting the teat valve is manufactured using a thinner silicone than the teat itself and therefore care needs to be taken during cleaning to ensure no damage is caused.
  - ✗ **DO NOT USE A TEAT BRUSH** or any other implement to clean the easi-vent™ valve/the feeding hole as damage such as splits and tears may occur. However, performance of the teat may be affected if the easi-vent™ valve is not cleaned thoroughly after each use. Ensure valve is flushed with warm water during cleaning.

### QUICK START:

- 1 Before use, wash **all** parts in warm soapy water, rinse in clean water and sterilise.
- 2 Assemble your bottle as per the above diagram.
- 3 When assembling your bottle it is important that you check the valve (C) by holding it to the light to check that the slit in the silicone has not sealed closed. If it has sealed closed, pinch it gently between your fingers to re-open. If the valve has sealed closed your bottle will not vent properly.
- 4 Make up your feed.
- 5 Serve.
- 6 After use, **wash all** parts in warm soapy water, rinse in clean water, ready to sterilise once more.

### STORAGE & USE

- ✓ Inspect before each use and pull the feeding teat in all directions. Throw away at the first signs of damage or weakness.
- ✓ Keep all components not in use out of reach of children.
- ✓ For safety and hygiene reasons it is recommended that the feeding teat is replaced every 2 months.

- 
- ✗ Do not store or leave in direct sunlight or near a source of heat or leave in disinfectant ("Sterilising Solution") for longer than recommended, as this may weaken the teat.
  - ✗ Do not store with or allow to come into contact with solvents or harsh chemicals.
  - ✗ Not suitable for use in a conventional oven or a combination microwave oven with the grill feature switched on.
  - ✗ Do not heat in a microwave with bottle sealed. Remove teat, locking ring and dome cap.

### WARNINGS

#### FOR YOUR CHILDS SAFETY & HEALTH WARNING!

- ✓ Always use this product with adult supervision. Accidents have occurred when babies have been left alone with drinking equipment due to the baby falling or if the product has been disassembled.
  - ✓ Always check food temperatures before feeding. Heating in a microwave oven may produce localised high temperatures. Take extra care when microwave heating.
  - ✓ Always stir heated food to ensure even heat distribution and test the temperature before serving.
  - ✓ When making up a feed, follow the formula milk manufacturer's instructions and allow the freshly boiled water to cool before pouring it into the bottle.
- 
- ✗ Never use feeding teats as a soother.
  - ✗ Continuous and prolonged sucking of fluids will cause tooth decay. Tooth decay in young children can occur even when non-sweetened fluids are used. This can occur if the baby is allowed to use the bottle for long periods through the day and particularly through the night, when saliva flow is reduced or if it is used as a soother.

Mayborn Baby and Child  
Northumberland Business Park West  
Cramlington Northumberland NE23 7RH, UK  
Mayborn Baby and Child  
is a trading style of Jackel International Limited.  
Copyright © Jackel International Limited 2012.